

The GYS SPOT 100R-C is a spot welder inverter type air cooled blown. This spotter allows the welding of galvanized steels and high strength steels. The clamping force to the electrodes can reach 300 daN and the effective welding current can reach 10 000 A (R.M.S. value).

GYS SPOT 100R-C has the traceability of welding spots.

DESCRIPTION

Ideal clamp for all types of metal works

- Lightweight and easy to handle: Weight : 4 kg (with C1 arm).
- Single-sided welding tool with 3 meter cable: spot hammer welding, stud/rivet/ring welding, carbon shrinking
- Accessory box
- Support cable bracket with a telescopic arm
- Control display 6"

10 000 A
300 daN

PERFORMANCE

- Welding current:
 - High welding current 10 000 A
 - Digital display of the actual current value
 - Sound alert if the welding current is too low
 - Constant current control
- Electrode force:
 - Electrode force control
 - Digital display of the actual electrode arms force
 - High clamping force: 300 daN with at 7 bar
 - Sound alert if the actual clamp force is too low

MACHINE INTERFACE

- User friendly: Large display (6"), with intuitive menus
- Saving of user welding parameters
- Easy: Only 2 parameters to be selected (thickness and steel sheet t_{max})

TRACEABILITY

- Record on SD card of the characteristics of each welding spot performed
- Restoration on any PC of the reports saved on the SD card



Made in FRANCE

INCLUDED

Monopoint/Spot welding
Ref. 049291



Spotter Box Pro
Ref. 050075



Inertia hammer
Ref. 049482 + 049802



Delivered with a set of 3 arms RC1 RC2 RC3

LxP= 106X34 mm LxP= 160X80 mm
incliné à 15°

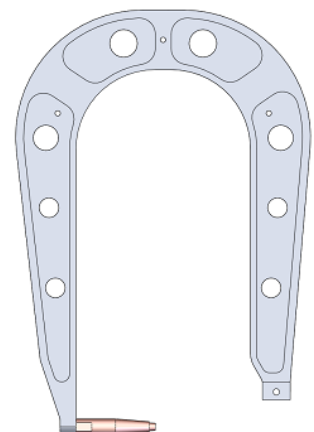
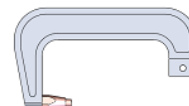

LxP= 220X450 mm

50/60Hz	32 (D)	I RMS 3% A	3+3	1,5+3	U ₀ 16	Câbles			100% Cu	70 x 99 x 208 cm	103 kg
						AIR COOLED	I	Ø mm ²			
3x400	32 (D)	10000	3+3	1,5+3	16	•	2,5m	200	•	70 x 99 x 208	103
						•	3m	150			
						—	8m	4x6 H07RNF			



CE
NF EN 50063